

AIMaker X tēmi

創科@大埔2022

Hello!



登記 **TEMI** 的 Admin

先在手機上 **Download & Install “TEMI APP”**



按app內步驟登記資料

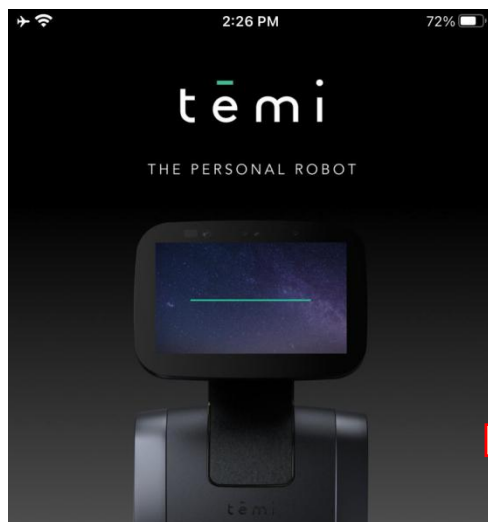

Tap `Agree & Continue` to accept the [temi terms & conditions](#)

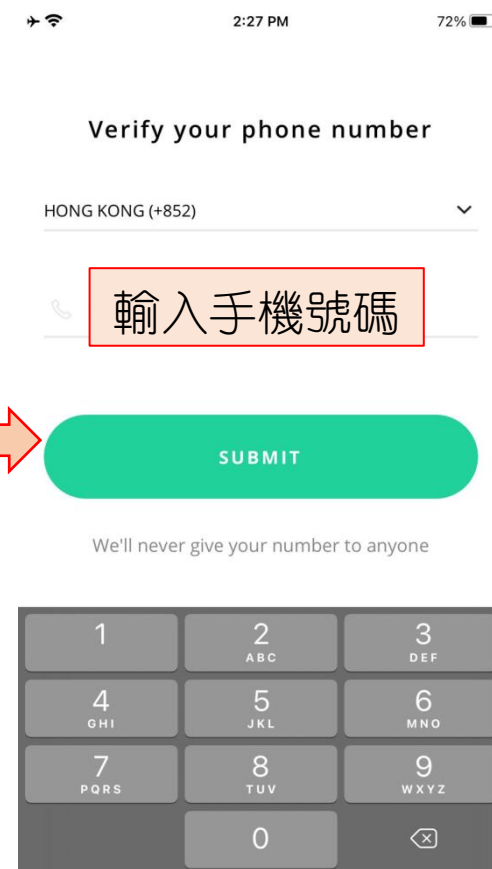
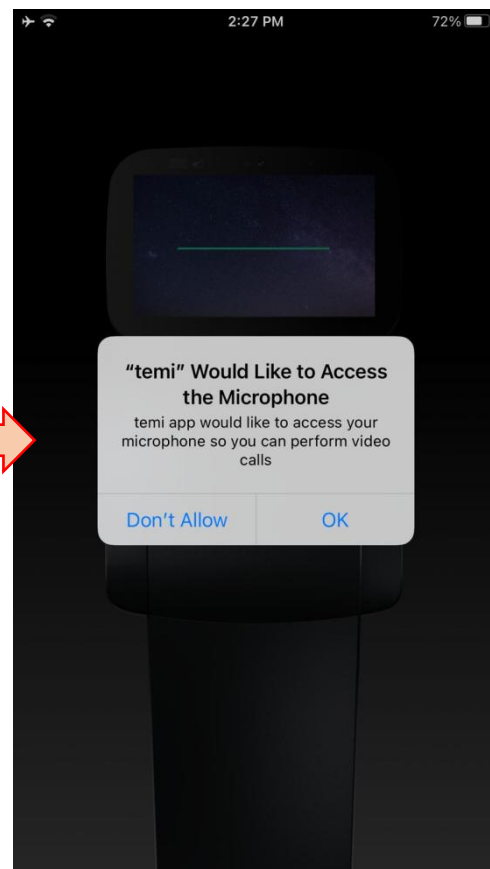
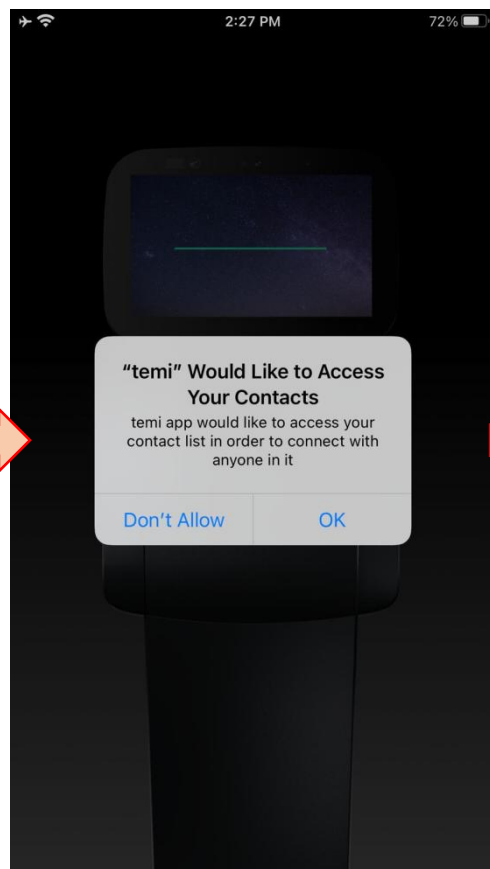

按app內步驟登記資料

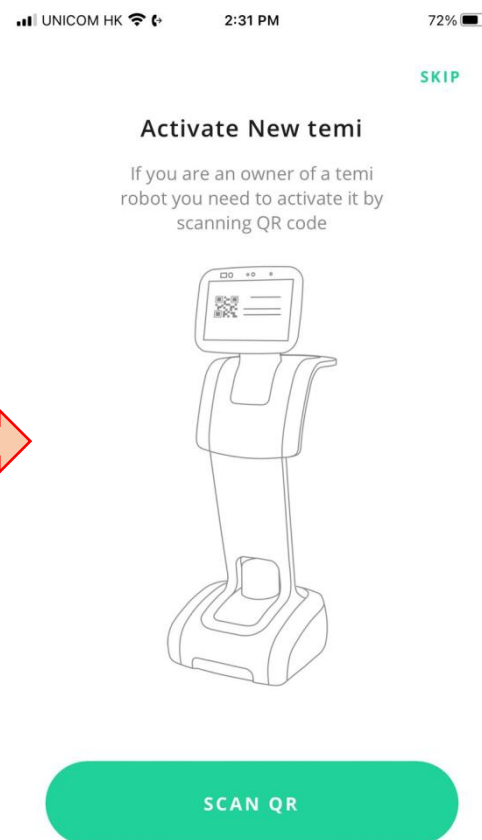
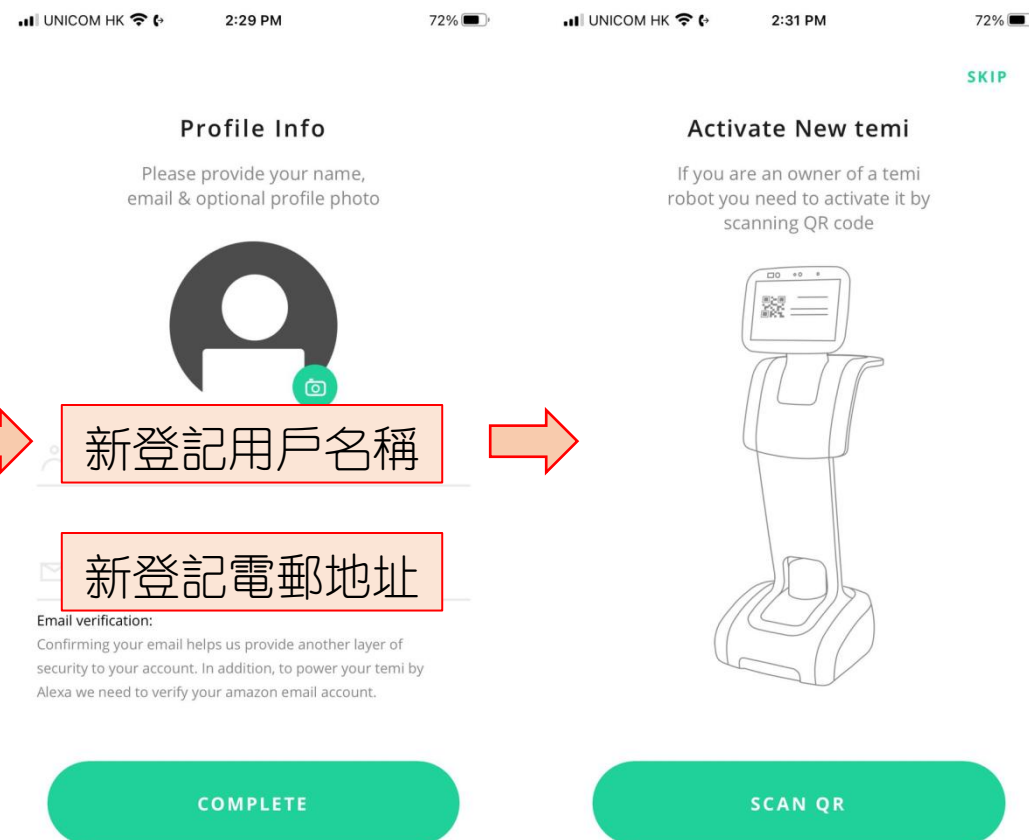
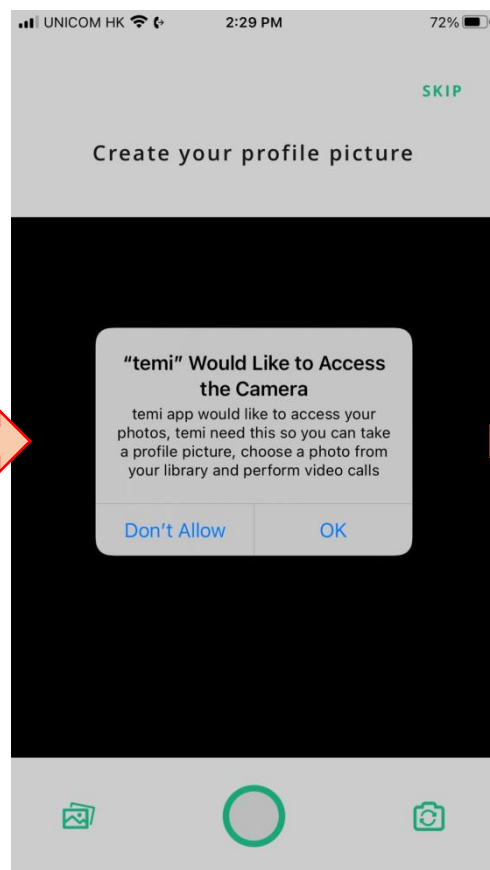
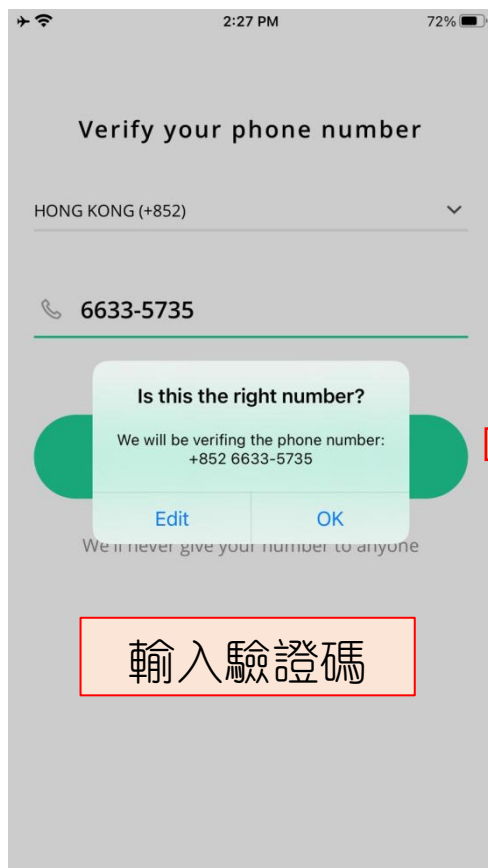

SKIP

Activate New temi

If you are an owner of a temi robot you need to activate it by scanning QR code

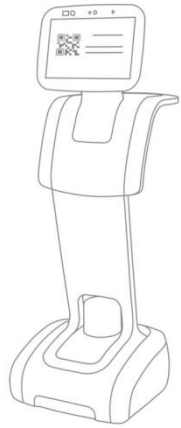

SCAN QR

Turn on TEMI Robot

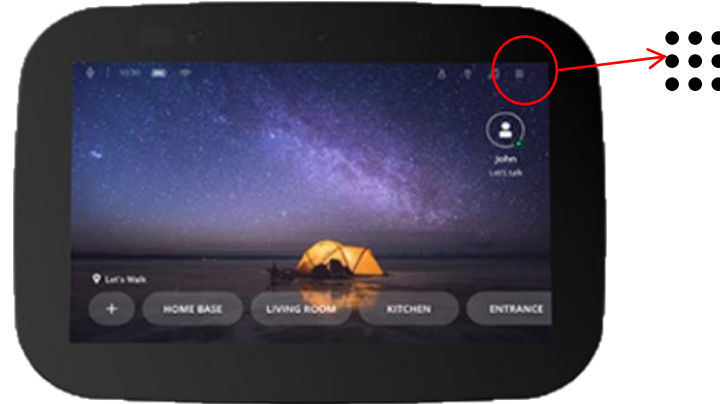

Select

Remote Temiscript

Scan the QR Code on your TEMI Screen



將登記電話同電郵發送到

Contact : Robocore AI Support (1)

Tel : 9359 4671

Whatsapp : <https://api.whatsapp.com/send?phone=85293594671>



然後等待 **Robocore** 回覆

連接 AIMaker Super Controller 控制 TEMI

1. 保持 **TEMI** 上網
2. 保持連接電腦上網
3. 配有藍牙功能並使用 **Win 10** 或以上的 **PC** 到 **scratch.aimakerhk.com**
4. 左下角新增 **code library**

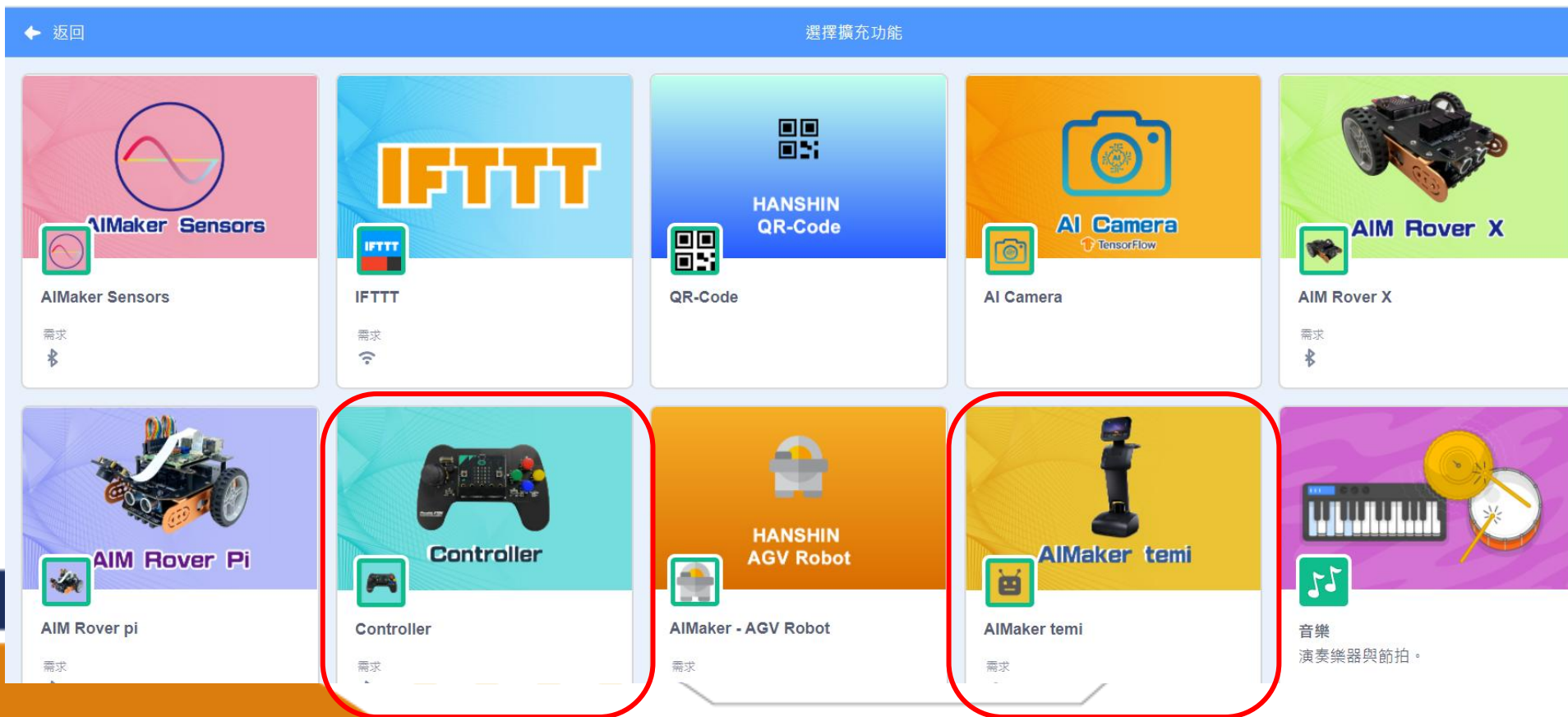

連接 AIMaker Super Controller 控制 TEMI

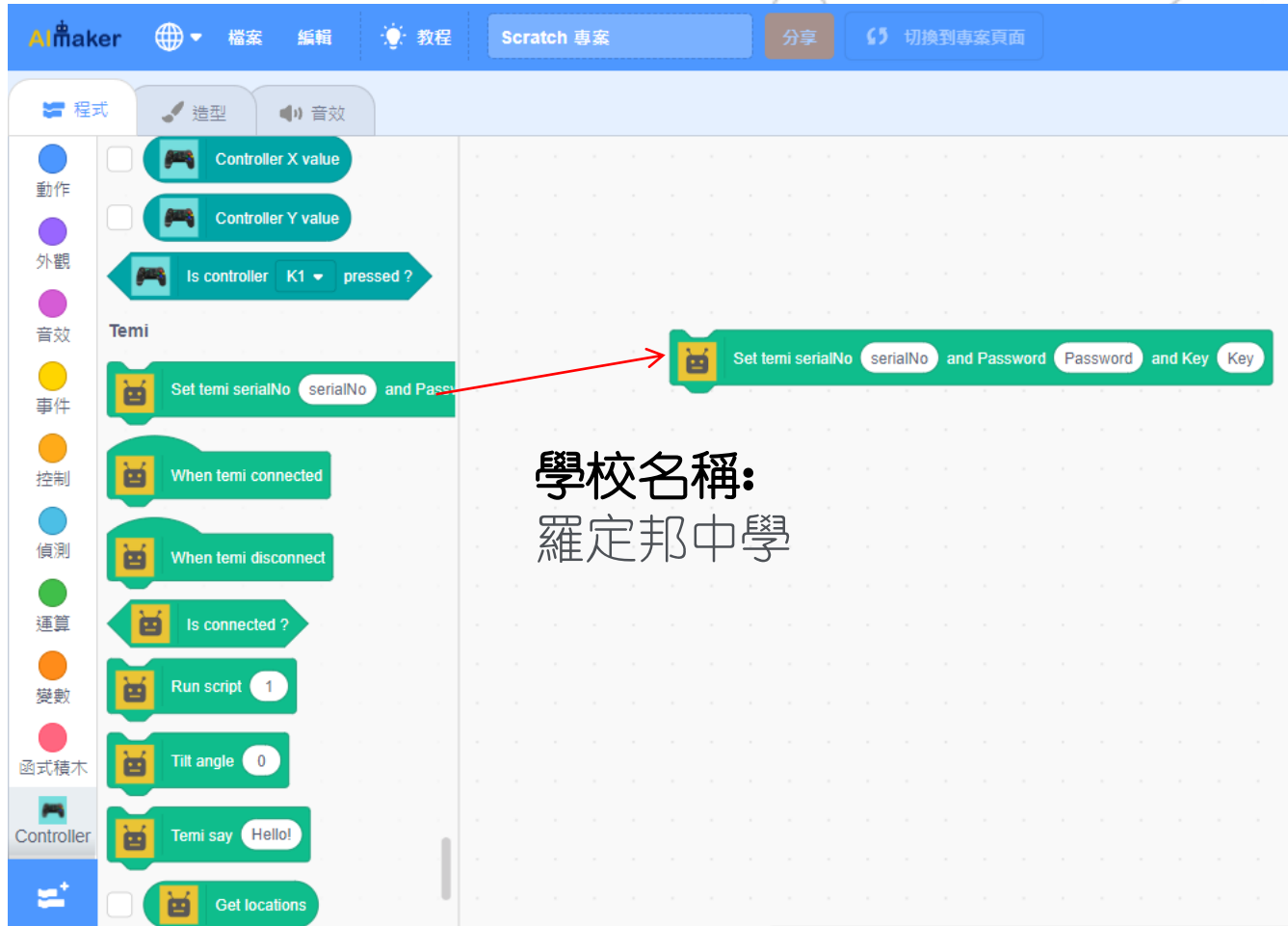

學校名稱:
羅定邦中學

Temi SN
00119140058

Key
EZPJIMHTE

Password 是學校開機登錄 **TEMI** 設定的密碼

```
When controller Forward  
Forward
```

```
When controller Left  
Turn left
```

```
When controller Right  
Turn right
```

```
When controller Backward  
Backward
```

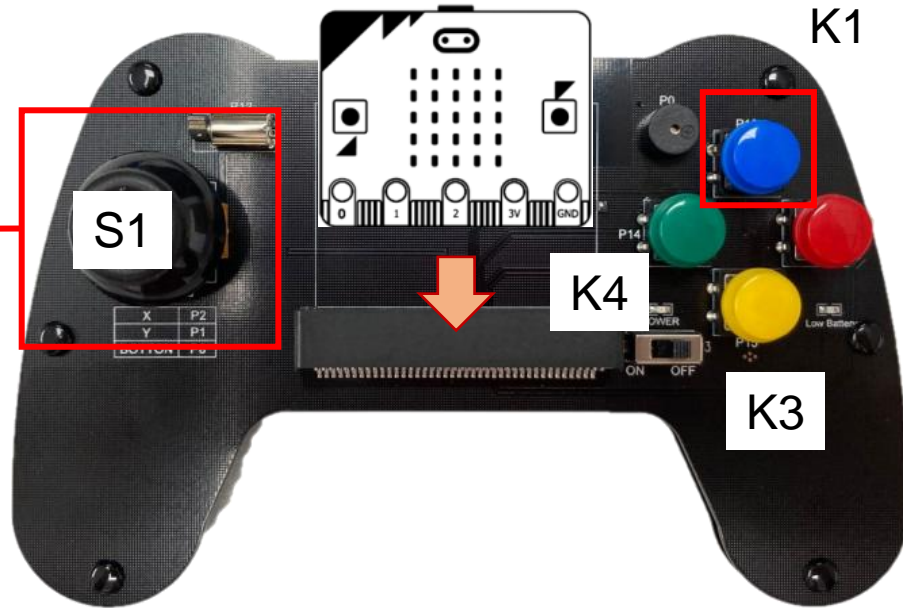

```
When K1 key pressed  
- [ ] K1  
- [ ] K2  
- [ ] K3  
- [ ] K4  
- [ ] S1
```

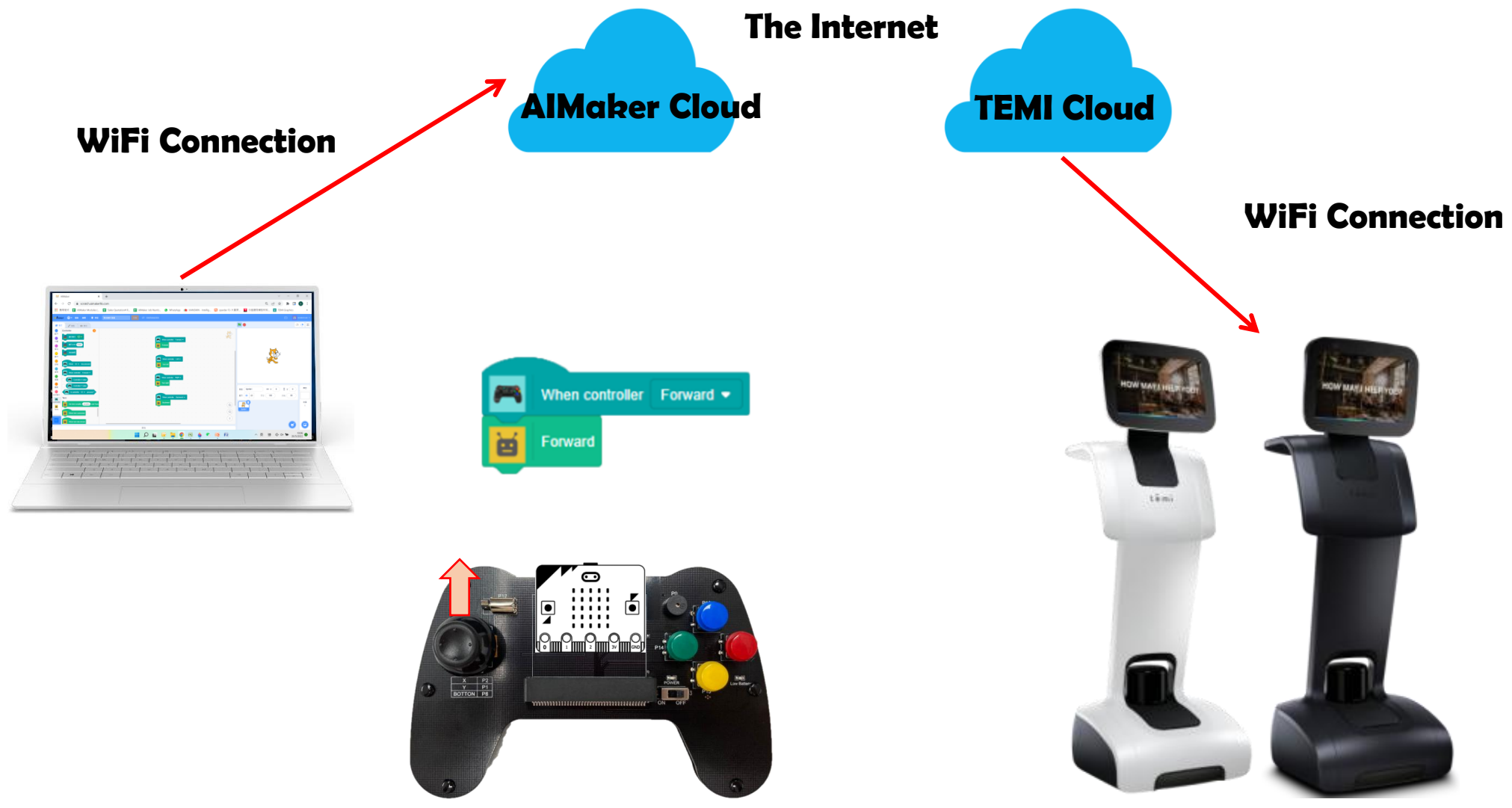

```

When K1 key pressed
  Initialize ambient light sensor at pin P1
  Repeat until Read light value at pin P1 > 300
  Show text Read light value at pin P1
  Go to location Location
  
```

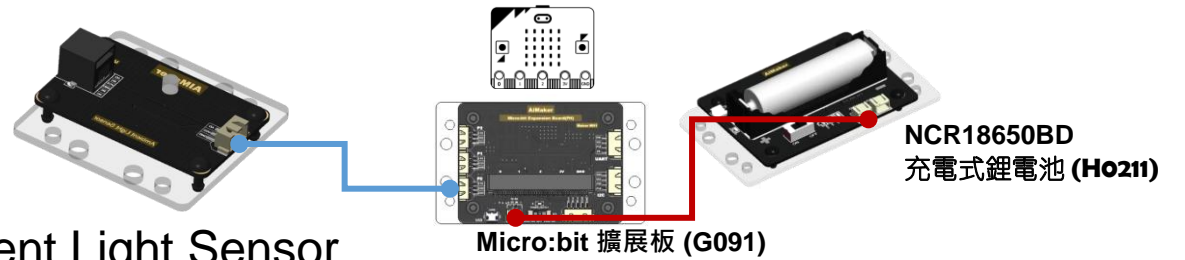
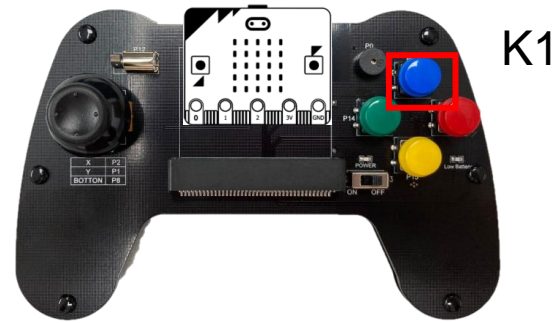

```

When K2 key pressed
  Set termi serialNo serialNo and Password Password and Key Key
  
```



Go to Location



AI Maker

Brings STEM Technologies to Schools

如有疑問，歡迎與我們聯絡

